

APPENDIX C.03
CASE 10-T-0139
SITE PLANS AND CONSTRUCTION DRAWINGS
SITE PLAN – PAVEMENT
ASTORIA HVDC CONVERTER STATION - SEGMENT 22

ASTORIA HVDC CONVERTER STATION

SITE PAVEMENT PACKAGE

SCOPE OF WORK

THE SITE PAVEMENT SCOPE OF WORK INCLUDES THE FOLLOWING:

- 1. PAVEMENT DESIGN
- 2. SURFACE TREATMENT/MATERIALS OUTSIDE OF PAVEMENT LIMITS

FLOOD ZONE DESIGN CERTIFICATION:

THE EXISTING PROPERTY IS IN THE SPECIAL FLOOD HAZARD AREA (SFHA), ZONE AE PER EFFECTIVE 2015 FLOOD INSURANCE RATE MAP(FIRM). THIS IS TO CONFIRM THAT THE PROPOSED INSTALLATION IS IN COMPLIANCE WITH THE REQUIREMENTS SET FORTH IN APPENDIX Q OF THE NYC BUILDING CODE.

NYC ENERGY CODE COMPLIANCE:

STATEMENT: TO THE BEST OF MY KNOWLEDGE, BELIEF AND PROFESSIONAL JUDGEMENT, THESE PLANS AND SPECIFICATIONS ARE IN COMPLIANCE WITH THE NEW YORK CITY ENERGY CONSERVATION CODE. PROPOSED WORK MEETS THE GUIDELINES AND INSTRUCTIONS OUTLINED IN THE 2020 NYC ECC CHAPTER 4.

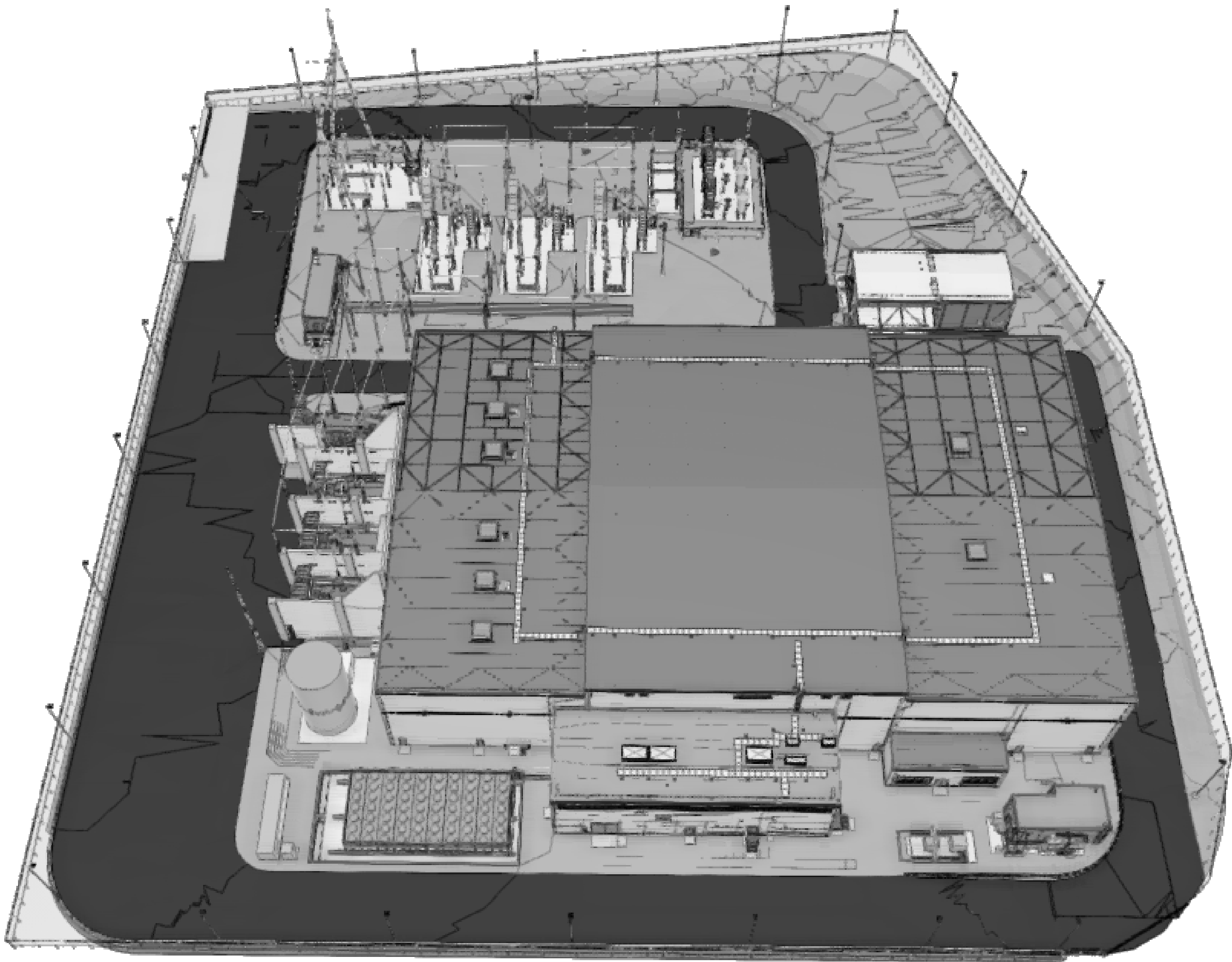

1 OVERALL SITE VIEW
T-001.00 N.T.S.

ISSUED FOR PERMIT

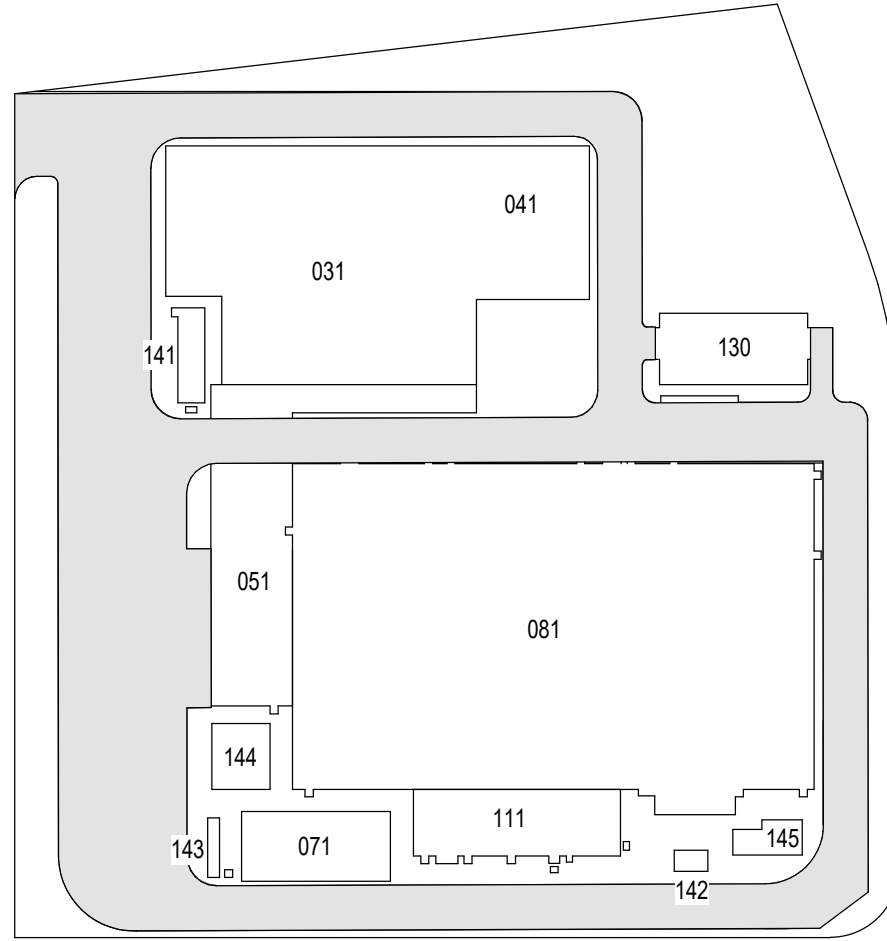

KEY PLAN
N.T.S.

PLAN NORTH

N

**Engineering and
Land Surveying, P.C.**

370 7th Avenue
SUITE 1604
New York, NY 10001

**SOWINSKI
SULLIVAN**
ARCHITECTURE+ENGINEERING

25 Mohawk Avenue
Sparta, NJ 07871

CONFIDENTIAL

THESE DRAWINGS ARE CONFIDENTIAL IN NATURE. ANY MISUSE OR UNAUTHORIZED DISTRIBUTION OF THE DRAWINGS CONTAINED HEREIN WILL BE A VIOLATION OF THIS CONFIDENTIALITY REQUIREMENT AND SUBJECT THE VIOLATOR TO LIABILITY. REVIEW OF THESE MATERIALS BY RECEPTOR SHALL CONSTITUTE ACCEPTANCE OF THESE TERMS AND THE TERMS OF ANY UNDERLYING CONFIDENTIALITY AGREEMENT WE MAY HAVE. EXCLUDED IN OBTAINING THIS INFORMATION FROM A THIRD PARTY. IF THE RECIPIENT IS NOT IN AGREEMENT WITH THE OBLIGATION OF CONFIDENTIALITY THEN THE DRAWINGS SHALL BE RETURNED TO THE ORIGINATOR.

B	FINAL SUBMISSION	VSP	EK	11/08/2022
A	INTERIM SUBMISSION	VSP	EK	09/13/2022
REV	DESCRIPTION	DRW BY	CHK BY	DATE

Kiewit
470 Chestnut Ridge Rd # 2,
Woodcliff Lake, NJ 07677

Hitachi Energy
901 Main Campus Drive
Raleigh, North Carolina 27606

PROJECT

CHPE
Champlain Hudson
Power Express

**Astoria HVDC
Converter Station**

31-45 20th Avenue, Astoria, Queens NY 11105
Block #850 - Lot #310 - BIN #4624437

COVER SHEET

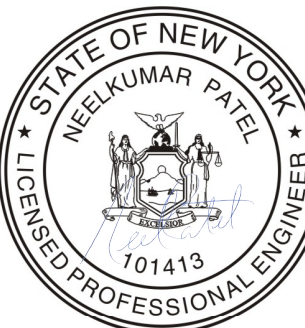

DATE 11/08/2022
PROJECT NO 105121
DRAWING BY V. PATEL
CHECKED BY E. KIDANE
DRAWING NO
T-001.00
CADD FILE NO
AstoriaHVDC-CoverSheet.rvt
1 of 6

GENERAL NOTES:

1. THE PLANS SHOW SUBSURFACE STRUCTURES, ABOVE GROUND STRUCTURES, AND/OR UTILITIES FROM FIELD LOCATION AND RECORD MAPPING, EXACT LOCATION OF WHICH MAY VARY FROM THE LOCATIONS INDICATED. IN PARTICULAR, THE CONTRACTOR IS WARNED THAT THE EXACT OR EVEN APPROXIMATE LOCATION OF SUCH PIPELINES, SUBSURFACE STRUCTURES, AND/OR UTILITIES IN THE AREA MAY BE DIFFERENT FROM THAT SHOWN OR MAY NOT BE SHOWN, AND IT SHALL BE HIS RESPONSIBILITY TO PROCEED WITH GREAT CARE IN EXECUTING ANY WORK. 48 HOURS BEFORE YOU DIG, DRILL, OR BLAST, CALL UNDERGROUND FACILITIES PROTECTION ORGANIZATION (UFGO) 1-(800)-962-7962 TOLL FREE.
2. THE ENGINEER SHALL BE NOTIFIED IN WRITING OF ANY CONDITIONS THAT VARY FROM THOSE SHOWN ON THE PLANS. THE CONTRACTOR'S WORK SHALL NOT VARY FROM THE PLANS WITHOUT THE PRIOR APPROVAL OF THE ENGINEER.
3. THE CONTRACTOR SHALL PROTECT AND PRESERVE ALL PUBLIC AND PRIVATE PROPERTY, INCLUDING ALL EXISTING VEGETATION, EXISTING LANDSCAPE FEATURES, AND MONUMENTS WITHIN, ALONG, AND ADJACENT TO THE PROPERTY. ALL AREAS DISTURBED BY THE CONTRACTOR SHALL BE RESTORED TO A PLEASING AND ACCEPTABLE CONDITION.
4. THE CONTRACTOR SHALL BE RESPONSIBLE FOR OBTAINING AND INCURRING THE COST OF ALL REQUIRED PERMITS, INSPECTIONS, CERTIFICATES, ETC. AND SHALL COMPLY WITH ALL REQUIRED PERMITS.
5. ALL WORK SHALL BE DONE IN STRICT COMPLIANCE WITH ALL APPLICABLE NATIONAL, STATE, AND LOCAL CODES, STANDARDS, ORDINANCES, RULES, AND REGULATIONS.
6. ALL PROPOSED UTILITIES AND APPURTENANCES SHALL BE CONSTRUCTED IN COMPLIANCE WITH THE LOCAL MUNICIPALITIES' CODES AND REGULATIONS GOVERNING THE INSTALLATION OF SUCH UTILITIES.
7. THE ENGINEER RESERVES THE RIGHT TO EXAMINE ANY WORK DONE ON THIS PROJECT AT ANY TIME TO DETERMINE THE CONFORMANCE WITH THE REQUIREMENTS OF THE CONTRACT DOCUMENTS OF THIS PROJECT.
8. THE CONTRACTOR SHALL PROTECT EXISTING PROPERTY LINE MONUMENTATION. ANY MONUMENTATION DISTURBED OR DESTROYED, AS JUDGED BY THE ENGINEER OR OWNER, SHALL BE REPLACED AT THE CONTRACTOR'S EXPENSE UNDER THE SUPERVISION OF A NEW YORK STATE LICENSED LAND SURVEYOR.
9. IT IS THE CONTRACTOR'S RESPONSIBILITY TO EXAMINE ALL PLAN SHEETS AND COORDINATE WORK WITH ALL OTHER CONTRACTS FOR THE SITE.
10. THE CONTRACTOR SHALL:

10.A. VERIFY ALL CONDITIONS IN THE FIELD PRIOR TO COMMENCEMENT OF WORK AND NOTIFY THE ENGINEER OF ANY DISCREPANCIES.

10.B. EXAMINE THE SITE AND INCLUDE IN HIS WORK THE EFFECT OF ALL EXISTING CONDITIONS ON THE WORK.

10.C. PROVIDE AND INSTALL ALL MATERIALS AND PERFORM ALL WORK IN ACCORDANCE WITH GOOD STANDARD PRACTICE.
11. ALL TRENCH EXCAVATION AND ANY REQUIRED SHEETING AND SHORING SHALL BE DONE IN ACCORDANCE WITH THE LATEST REVISIONS OF NEW YORK CITY BUILDING CODE CHAPTER 33 AND OSHA REGULATIONS FOR CONSTRUCTION. SHEET PILING SHALL BE DESIGNED AND SEALED BY A NEW YORK STATE LICENSED PROFESSIONAL ENGINEER.
12. CONTRACTOR SHALL BE RESPONSIBLE FOR ROUTINE DEWATERING RELATED TO THE MAINTENANCE OF SURFACE DRAINAGE DURING THE COURSE OF WORK. CONTRACTOR SHALL MAINTAIN EXISTING SITE DRAINAGE PATTERNS THROUGHOUT CONSTRUCTION UNLESS OTHERWISE SHOWN ON THE PLANS. DEWATERING FOR MAJOR CONSTRUCTION ITEMS IS NOT THE RESPONSIBILITY OF THE CONTRACTOR AND SHALL BE PERFORMED BY TDI.
13. CONTRACTOR SHALL NOT DISRUPT SERVICE TO ANY UTILITIES WITHOUT PRIOR COORDINATION WITH UTILITY OWNER.
14. ALL FRAMES/COVERS WITHIN PAVED AREAS SHALL HAVE THE TOPS SET FLUSH WITH THE FINAL PAVEMENT GRADE. IN LANDSCAPED AREAS, ALL FRAMES SHALL BE 0.1' ABOVE GRADE.
15. THE CONTRACTOR SHALL BE RESPONSIBLE FOR PROVIDING ALL FIELD LAYOUT. THE CONTRACTOR SHALL PROVIDE MARKED-UP AS-BUILT PLANS FOR ALL UTILITIES SHOWING TIE-IN AND CONNECTIONS, BENDS, VALVES, LENGTHS OF LINES, AND INVERTS. AS-BUILT PLANS FOR ALL UTILITIES SHOWING TIES TO CONNECTIONS, BENDS, VALVES, LENGTHS OF LINES, AND INVERTS. AS-BUILT PLANS SHOWING ALL UNDERGROUND UTILITIES INSTALLED OR ENCOUNTERED SHALL BE SUBMITTED TO THE OWNER AND HIS REPRESENTATIVES.
16. CONTRACTOR SHALL MAINTAIN ALL TRAFFIC IN ALL AREAS (INCLUDING THE ADJACENT ROADWAYS TO THE SITE AND CONSTRUCTION VEHICLE ENTRANCE AND EXIT TO THE SITE) AS PER COORDINATION WITH ADJACENT PROPERTY OWNERS.
17. ALL EXCAVATIONS SHALL BE PROTECTED AT THE END OF EACH WORK DAY.
18. CONTRACTOR SHALL TAKE CARE TO PREVENT DAMAGE TO EXISTING UTILITIES. DAMAGED UTILITIES SHALL BE IMMEDIATELY REPAIRED BY THE CONTRACTOR AT THE CONTRACTOR'S EXPENSE. IF DURING EXCAVATION PREVIOUSLY DAMAGED UTILITIES ARE UNCOVERED, CONTRACTOR SHALL DOCUMENT THE DAMAGE AND REPORT DAMAGE TO THE APPROPRIATE OWNER.
19. THE CONTRACTOR MUST COORDINATE HIS SCHEDULE OF OPERATIONS WITH THE VARIOUS UTILITY OWNERS INVOLVED WITH THE PROJECT AND SHALL VERIFY UTILITY INFORMATION FOUND IN THE CONTRACT DOCUMENTS.
20. PRIOR TO THE COMMENCEMENT OF CONSTRUCTION, TDI SHALL COORDINATE WITH ALL THE KNOWN PUBLIC AND PRIVATE UTILITY COMPANIES THAT MAY HAVE POTENTIAL IMPACT TO OVERHEAD AND UNDERGROUND UTILITIES FROM THE CONTRACTORS WORK. THE CONTRACTOR SHALL, AT THIS MEETING, INFORM THE UTILITY COMPANIES OF HIS SCHEDULE OF OPERATIONS SO THAT UTILITY COMPANIES PLAN AND SCHEDULE THEIR ACTIVITIES ACCORDINGLY.
21. THE CONTRACTOR IS GOVERNED BY AND MUST ADHERE TO THE PROVISIONS OF THE 16 NYCRR PART 753, "PROTECTION OF UNDERGROUND FACILITIES," AND ALL ITS AMENDMENTS; I.E. CALL 811 DIG SAFE PRIOR TO BREAKING GROUND
22. THE CONTRACTOR SHALL CONDUCT ALL OPERATIONS IN ACCORDANCE WITH ALL OSHA RULES AND REGULATIONS AND IN ACCORDANCE WITH NEW YORK STATE LABOR LAW, SECTION 202-H, "THE HIGH VOLTAGE PROXIMITY ACT."
23. REFER TO FLOOD INSURANCE RATE MAP (FIRM) NUMBER 3604970092G FOR THE PROJECT SITE. THE SPECIAL FLOOD HAZARD AREA TYPE IS ZONE AE AND X. BASE FLOOD ELEVATION IS 13' AND DESIGN FLOOD ELEVATION IS 15'.
24. EXISTING IMPERVIOUS SURFACE AREA WITHIN THE PROPERTY LIMITS TOTALS 4.36 ACRES, WHILE PROPOSED IMPERVIOUS SURFACE AREA TOTALS 7.77 ACRES.

FL FLOOD

- FL-1. THE SITE IS DEFINED AS A ZONE (NON-COASTAL).
- FL-2. BASE FLOOD ELEVATION, BFE, = 13 FEET NAVD 88.
- FL-3. RECOMMENDED FREE BOARD BY THE 2022 NYCBC-APPENDIX G IS 2.0 FEET.
- FL-4. RECOMMENDED DESIGN FLOOD ELEVATION, DFE = 15 FEET NAVD 88.
- FL-5. THE STRUCTURE IS NOT SUBJECTED TO HYDRODYNAMIC LOADS.

DESIGN ELEVATION / DEPTH	FEET IN NAVD 88
DESIGN BASE FLOOD ELEVATION	13.0
FINISH FLOOR ELEVATION	15.0
SEA LEVEL RISE	NOT CONSIDERED

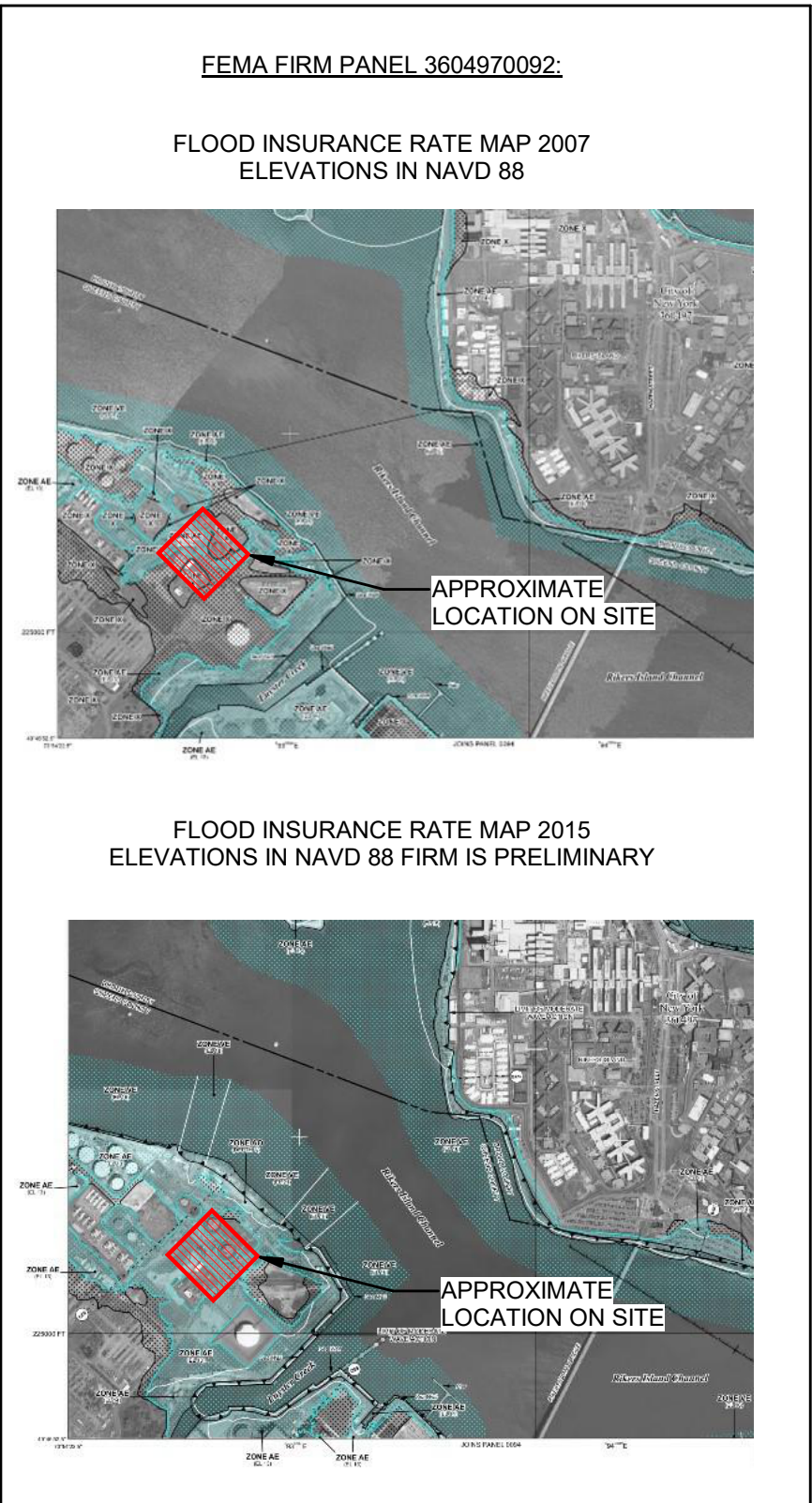

SITE CIVIL SHEET INDEX

DRAWING TITLE	DWG. NO.
GENERAL NOTES	C-001.00
LEGEND AND ABBREVIATIONS	C-002.00
OVERALL PAVEMENT PLAN	C-401.00
PAVEMENT AND MISCELLANEOUS SECTIONS - 1	C-402.00
PAVEMENT AND MISCELLANEOUS SECTIONS - 2	C-403.00

ISSUED FOR PERMIT

Engineering and
Land Surveying, P.C.

370 7th Avenue
SUITE 1604
New York, NY 10001

SOWINSKI
SULLIVAN
ARCHITECTURE+ENGINEERING

25 Mohawk Avenue
Sparta, NJ 07871

CONFIDENTIAL

THESE DRAWINGS ARE CONFIDENTIAL IN NATURE. ANY MISUSE OR UNAUTHORIZED DISTRIBUTION OF THE DRAWINGS CONTAINED HEREIN WILL BE A VIOLATION OF THIS CONFIDENTIALITY REQUIREMENT AND SUBJECT THE VIOLATOR TO LIABILITY. REVIEW OF THESE MATERIALS BY RECEIPT SHALL CONSTITUTE ACCEPTANCE OF THESE TERMS AND THE TERMS OF ANY UNDERLYING CONFIDENTIALITY AGREEMENT HE MAY HAVE. EXCLUDED IN OBTAINING THIS INFORMATION FROM A THIRD PARTY. IF THE RECIPIENT IS NOT IN AGREEMENT WITH THE OBLIGATION OF CONFIDENTIALITY THEN THE DRAWINGS SHALL BE RETURNED TO THE ORIGINATOR.

B	FINAL SUBMISSION	AB	JL	11/8/22	
A	INTERIM SUBMISSION	NS	JL	8/29/22	
REV	DESCRIPTION	DRW BY	CHK BY	DATE	



Kiewit

470 Chestnut Ridge Rd # 2,
Woodcliff Lake, NJ 07677

Hitachi Energy

901 Main Campus Drive
Raleigh, North Carolina 27606

LIST OF SPECIFICATIONS:

31 - EARTHWORK	310001	GENERAL PROVISIONS
32 - EXTERIOR IMPROVEMENTS	321216	ASPHALT PAVING

LIST OF SPECIAL INSPECTIONS:



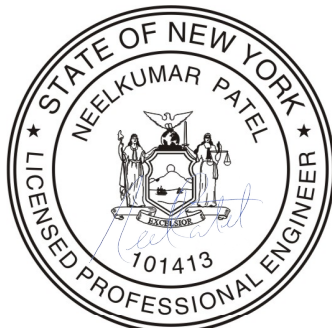

INSPECTION AND TEST	CODE/SECTION
SUBGRADE INSPECTION	BC 1704.7.1

GENERAL NOTES



DATE	NOVEMBER 8, 2022
PROJECT NO	105121
DRAWING BY	A.BUDARAPU
CHECKED BY	J.LLORENTE
DRAWING NO	C-001.00
CADD FILE NO	2 of 6

LEGENDS & SYMBOLS

	EXISTING PROPERTY LINE
	PROPOSED FENCE
	PROPOSED RETAINING WALL
	PROPOSED SECURITY GATE
	PROPOSED LIGHT POLE

ABBREVIATIONS

AASHTO = AMERICAN ASSOCIATION OF STATE HIGHWAY AND TRANSPORTATION OFFICIALS	OC = ON CENTER
AC = ALTERNATING CURRENT	OD = OUTER DIAMETER
AD = TANGENT OFFSET AT PVI	OSHA = OCCUPATIONAL SAFETY AND HEALTH ADMINISTRATION
APPROX = APPROXIMATE	PCC = PORTLAND CEMENT CONCRETE
ASCE = AMERICAN SOCIETY OF CIVIL ENGINEERS	PCD = PRECAST CONCRETE DUCTS
ASTM = AMERICAN SOCIETY OF TESTING AND MATERIALS	PVI = POINT OF VERTICAL INTERSECTION
BVCE = BEGINING OF VERTICAL CURVE ELEVATION	PVMT = PAVEMENT
BVCS = BEGINING OF VERTICAL CURVE STATION	STA = STATION
CB = CATCH BASIN	TYP = TYPICAL
CIP = CAST IN PLACE	RCP = REINFORCED CONCRETE PIPE
CONC = CONCRETE	RD = ROAD
DIA = DIAMETER	REQ'D = REQUIRED
DIP = DUCTILE IRON PIPE	REV = REVISION
DGA = DENSE GRADED AGGREGATE	RF = REAR FACE
E = EPOXY COATED REBAR	WM = WATER MAIN
ELEV = ELEVATION	WT = WEIGHT
EVCE = END OF VERTICAL CURVE ELEVATION	WWF = WELDED WIRE FABRIC
EVCS = END OF VERTICAL CURVE STATION	WZTC = WORK ZONE TRAFFIC CONTROL
EXIST = EXISTING	YR = YEAR
FF = FRONT FACE	
FDNY = NEW YORK CITY FIRE DEPARTMENT	
FFE = FINISHED FLOOR ELEVATION	
HDPE = HIGH DENSITY POLYETHYLENE	
HPBO = HEAVY POST BLOCK OUT	
HVAC = HEATING, VENTILATION AND AIR CONDITIONING	
HVE = HIGH VOLTAGE ELECTRIC	
ID = INNER DIAMETER	
IPS = IRON PIPE SIZE	
LBS = POUNDS	
LF = LINEAR FEET	
LVC = LENGTH OF VERTICAL CURVE	
MAX = MAXIMUM	
MH = MANHOLE	
MIN = MINIMUM	
MPT = MAINTENANCE AND PROTECTION OF TRAFFIC	
MTS = MANUAL TRANSFER SWITCH	
MVS = MEDIUM VOLTAGE SWITCHGEAR	
N/A = NOT APPLICABLE	
NTS = NOT TO SCALE	
NYC = NEW YORK CITY	
NYCDOT = NEW YORK CITY DEPARTMENT OF TRANSPORTATION	
NYCDEP = NEW YORK CITY DEPARTMENT OF ENVIRONMENTAL PROTECTION	
NYCRR = NEW YORK CITY CODES, RULES AND REGULATIONS	
NYSDOT = NEW YORK STATE DEPARTMENT OF TRANSPORTATION	

ISSUED FOR PERMIT

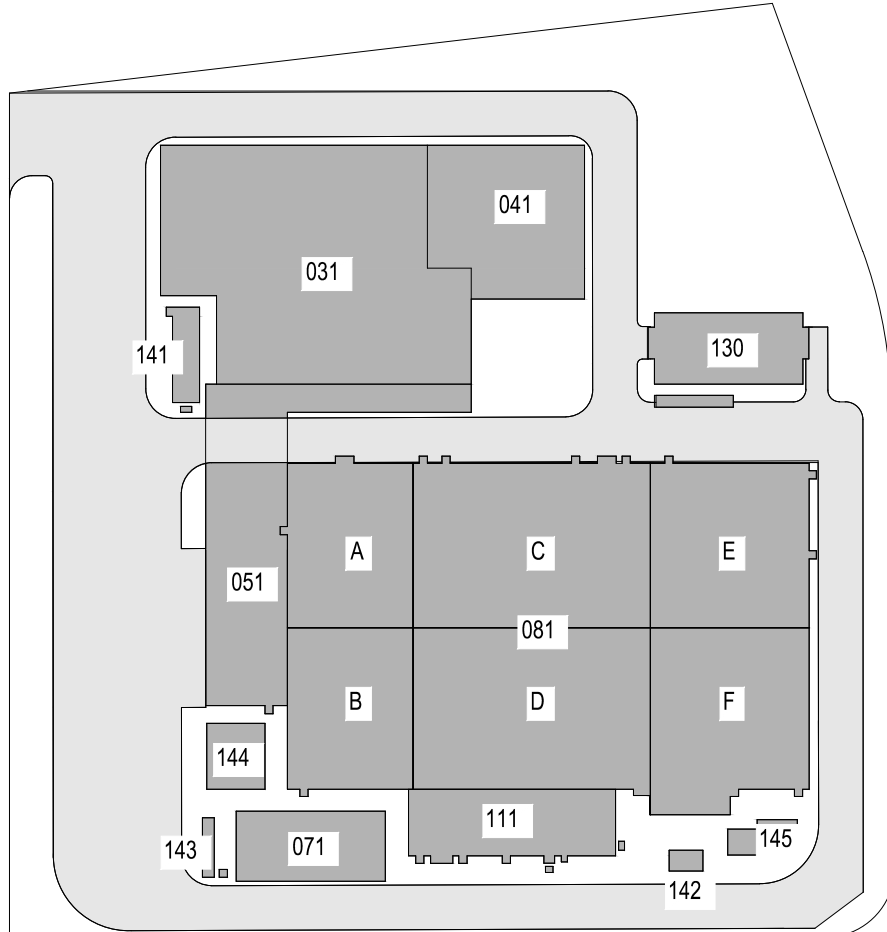

KEY PLAN
N.T.S.

K Engineering and
Land Surveying, P.C.

370 7th Avenue
SUITE 1604
New York, NY 10001

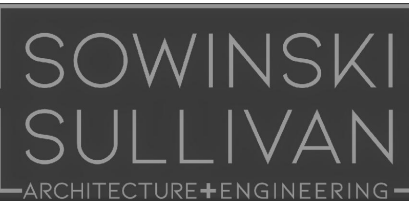

25 Mohawk Avenue
Sparta, NJ 07871

CONFIDENTIAL

THESE DRAWINGS ARE CONFIDENTIAL IN NATURE. ANY MISUSE OR UNAUTHORIZED DISTRIBUTION OF THE DRAWINGS CONTAINED HEREIN WILL BE A VIOLATION OF THIS CONFIDENTIALITY REQUIREMENT AND SUBJECT THE VIOLATOR TO LIABILITY. REVIEW OF THESE MATERIALS BY RECEIPT SHALL CONSTITUTE ACCEPTANCE OF THESE TERMS AND THE TERMS OF ANY UNDERLYING CONFIDENTIALITY AGREEMENT HE MAY HAVE. EXCLUDED IN OBTAINING THIS INFORMATION FROM A THIRD PARTY. IF THE RECIPIENT IS NOT IN AGREEMENT WITH THE OBLIGATION OF CONFIDENTIALITY THEN THE DRAWINGS SHALL BE RETURNED TO THE ORIGINATOR.

B	FINAL SUBMISSION	AB	JL	11/8/22
A	INTERIM SUBMISSION	MK	JL	8/28/22
REV	DESCRIPTION	DRW BY	CHK BY	DATE



Kiewit

470 Chestnut Ridge Rd # 2,
Woodcliff Lake, NJ 07677



901 Main Campus Drive
Raleigh, North Carolina 27606

PROJECT



**Astoria HVDC
Converter Station**

31-45 20th Avenue, Astoria, Queens NY 11105
Block #850 - Lot #310 - BIN #4624437

LEGEND AND ABBREVIATIONS

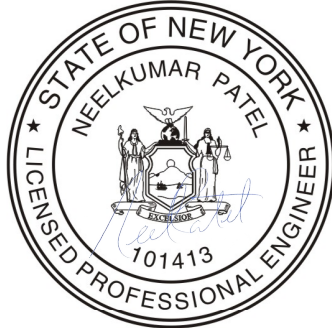

DATE	November 8, 2022
PROJECT NO	105121
DRAWING BY	M. KWOK
CHECKED BY	J.LLORENTE
DRAWING NO	C-002.00
CADD FILE NO	3 of 6

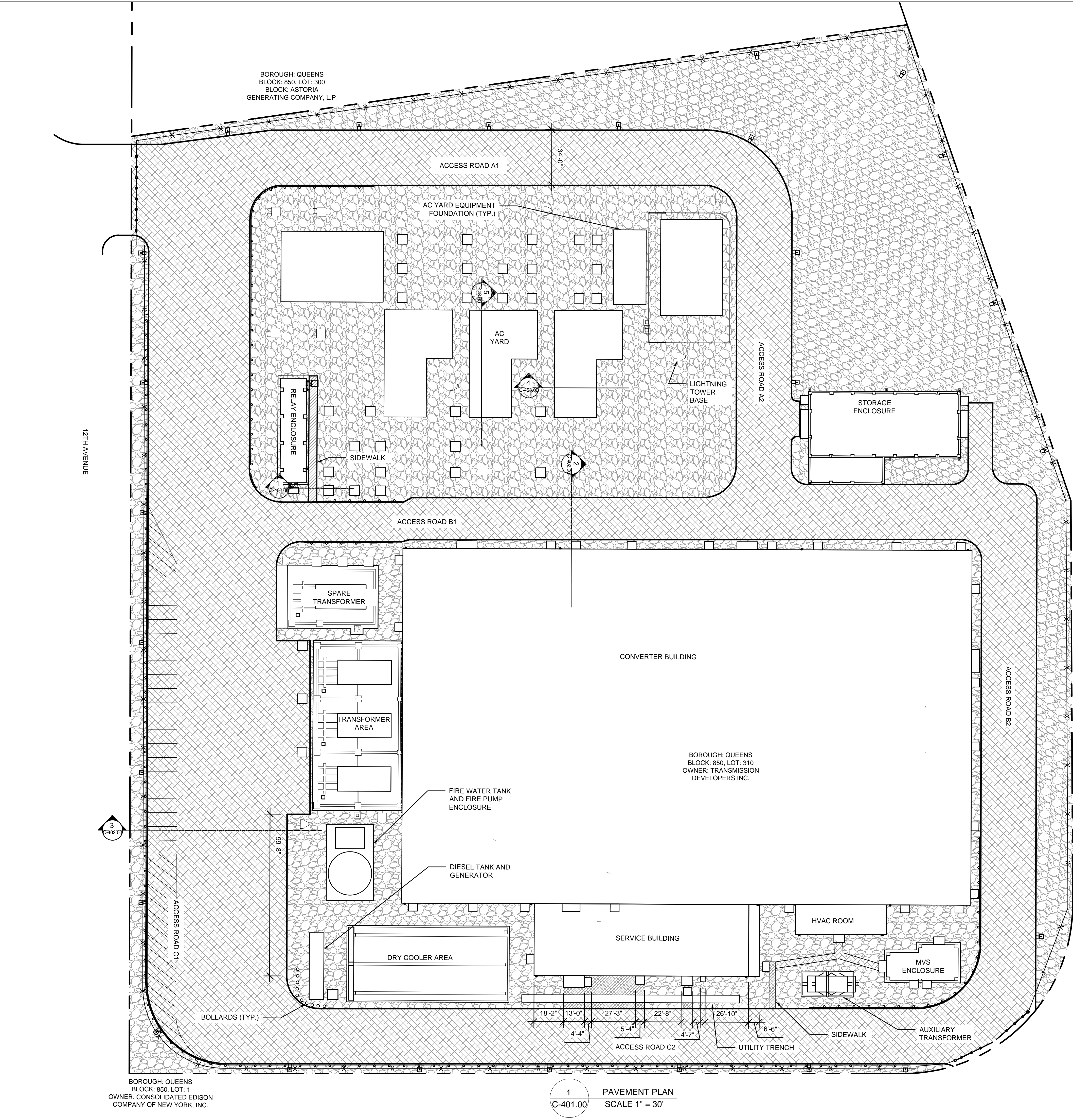

- CRUSHED GRAVEL SURFACE
- ASPHALT SIDEWALK
- ASPHALT PAVEMENT
- CONCRETE PAVERS

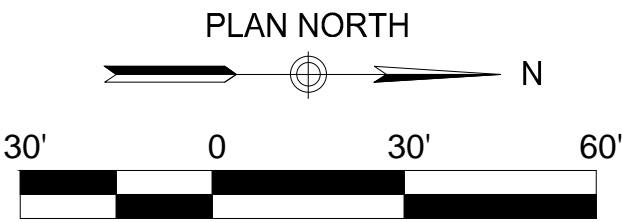

ISSUED FOR PERMIT

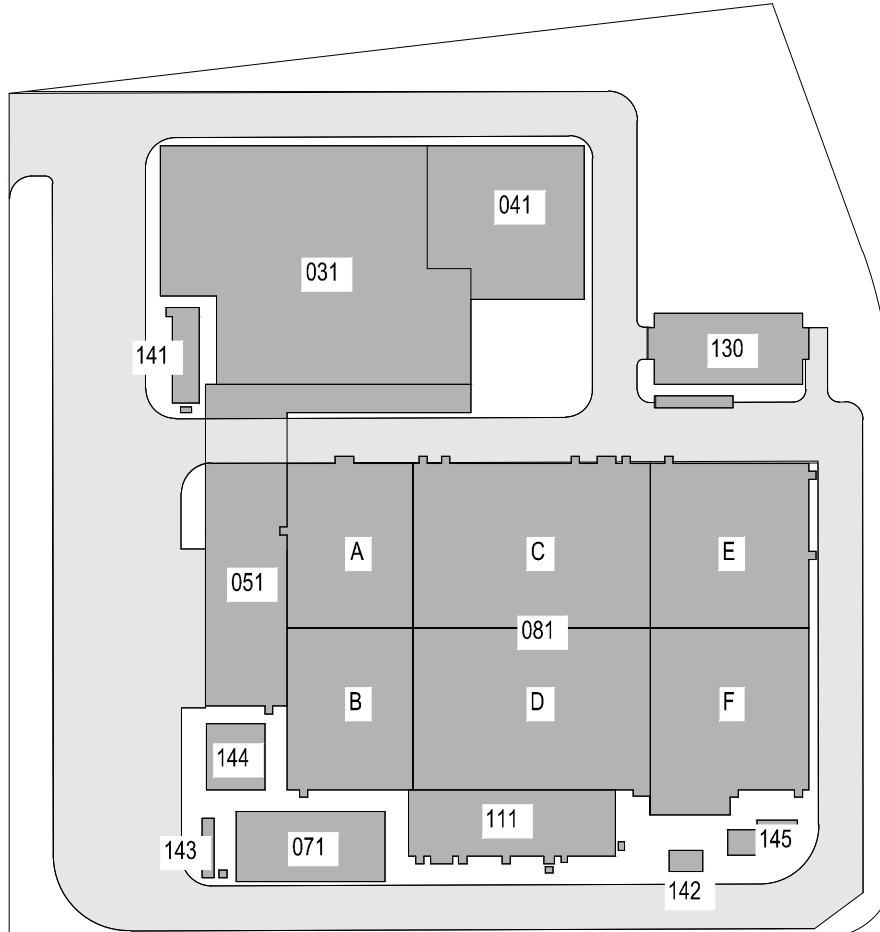

Engineering and
Land Surveying, P.C.

370 7th Avenue
SUITE 1604
New York, NY 10001

SOWINSKI
SULLIVAN
ARCHITECTURE+ENGINEERING

25 Mohawk Avenue
Sparta, NJ 07871

CONFIDENTIAL

THESE DRAWINGS ARE CONFIDENTIAL IN NATURE. ANY MISUSE OR UNAUTHORIZED DISTRIBUTION OF THE DRAWINGS CONTAINED HEREIN WILL BE A VIOLATION OF THIS CONFIDENTIALITY REQUIREMENT AND SUBJECT THE VIOLATOR TO LIABILITY. REVIEW OF THESE MATERIALS BY RECEPT SHALL CONSTITUTE ACCEPTANCE OF THESE TERMS AND THE TERMS OF ANY UNDERLYING CONFIDENTIALITY AGREEMENT WE MAY HAVE. EXCLUDED IN OBTAINING THIS INFORMATION FROM A THIRD PARTY. IF THE RECIPIENT IS NOT IN AGREEMENT WITH THE OBLIGATION OF CONFIDENTIALITY THEN THE DRAWINGS SHALL BE RETURNED TO THE ORIGINATOR.

REV	DESCRIPTION	DRW BY	CHK BY	DATE
A	FINAL SUBMISSION	AY	NP	11/8/22
A	INTERIM SUBMISSION	NS	NP	8/29/22

Kiewit

470 Chestnut Ridge Rd # 2,
Woodcliff Lake, NJ 07677

Hitachi Energy

901 Main Campus Drive
Raleigh, North Carolina 27606

PROJECT

CHPE
Champlain Hudson
Power Express

Astoria HVDC
Converter Station

31-45 20th Avenue, Astoria, Queens NY 11105
Block #850 - Lot #310 - BIN #4624437

OVERALL PAVEMENT PLAN

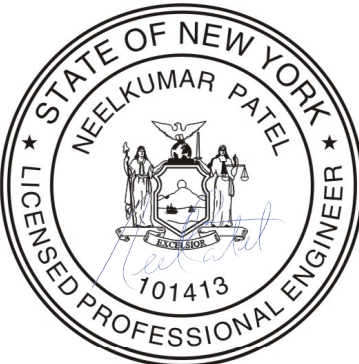

DATE
PROJECT NO
DRAWING BY
CHECKED BY
DRAWING NO
CADD FILE NO

NOVEMBER 8, 2022
105121
A. YOUSEF
N. PATEL
C-401.00
4 of 6

ISSUED FOR PERMIT

PAVEMENT CONSTRUCTION NOTES:

- PAVEMENT SUBGRADE SHALL BE COMPACTED TO AT LEAST 95% MAX. DRY DENSITY. AN ADDITIONAL LAYER OF DENSE-GRADED AGGREGATE (DGA) SHALL BE INSTALLED ON TOP OF THE COMPACTED SUBGRADE WHERE NEEDED TO MEET FINAL GRADE, AND SHALL BE COMPACTED TO AT LEAST 95% MAX. DRY DENSITY.
- SUBBASE COURSE SHALL BE COMPACTED IN PLACE WITH AT LEAST TWO PASSES OF A HAND-OPERATED VIBRATORY PLATE, LIGHT ROLLER, OR OTHER SUITABLE WALK-BEHIND EQUIPMENT.
- ALL PAVEMENT SURFACES SHALL SLOPE AWAY FROM BUILDINGS AND ENCLOSURES.

GRAVEL SURFACE NOTES:

- GRAVEL SURFACE COURSE SHALL BE 6" IN DEPTH AND CONSIST OF WASHED CLEAN UNIFORMLY GRADED CRUSHED ROCK WITH NO FINES TO ALLOW FOR FREE DRAINAGE. MATERIAL SHALL BE HARD ABRASION RESISTANT, DURABLE, GRANITE TYPE, ANGULAR OF SUB-ANGULAR CRUSHED ROCK.
- BACKFILL MATERIAL BENEATH THE GRAVEL SURFACE COURSE SHALL CONFORM TO NYSDOT AND NYPA SPECIFICATIONS AS APPROPRIATE. GROUNDING GRID FOR ELECTRICAL EQUIPMENT TO BE INSTALLED IN THIS LAYER. REFER TO SECTION 6.1 OF THE GEOTECHNICAL ENGINEERING REPORT FOR BACKFILL MATERIAL RECOMMENDATIONS (FILED UNDER A SEPARATE APPLICATION).
- MATERIAL RESISTIVITY PROPERTIES SHALL BE AS FOLLOWS:
 - GRAVEL SURFACE COURSE: 3000 Ω -m MIN. WHEN WET
 - BACKFILL LAYER: 500 Ω -m MAX.

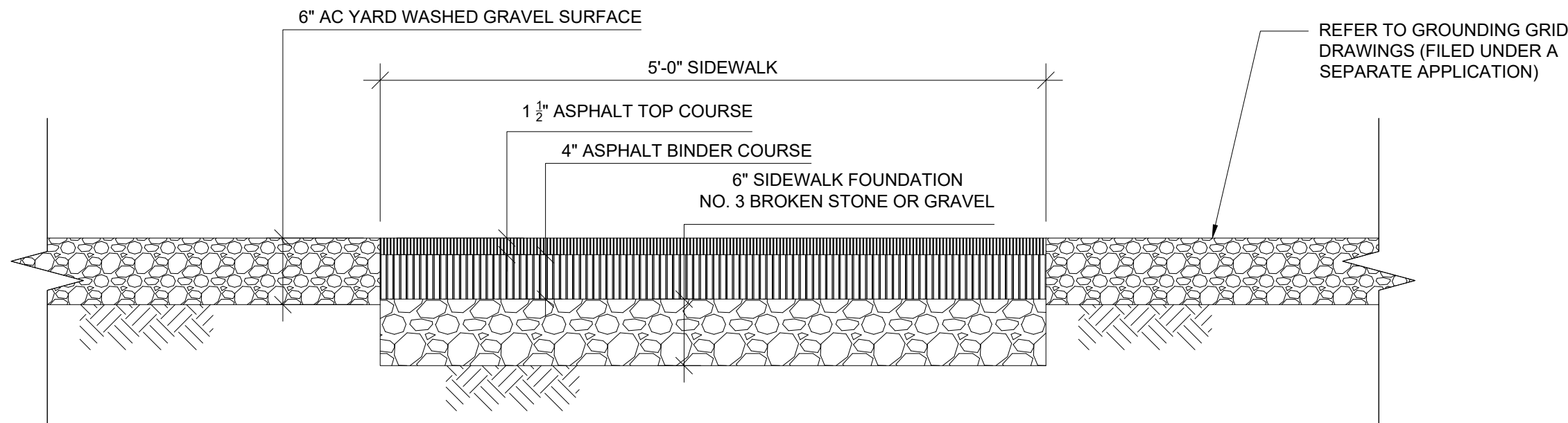

1 AC YARD SIDEWALK SECTION
C-401.00 SCALE 1" = 1'

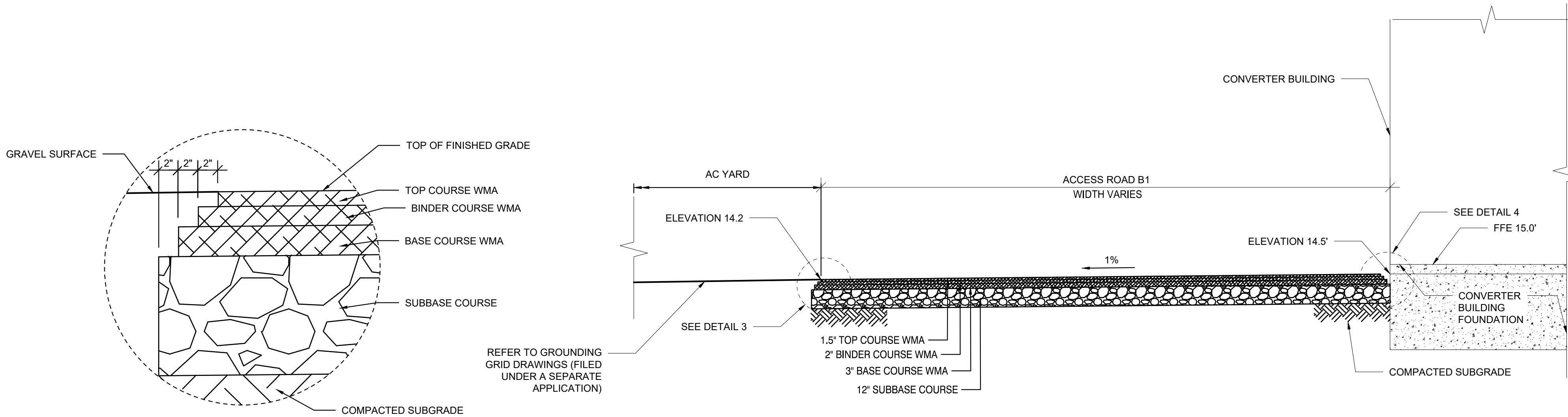

3 PAVEMENT STEP DETAIL
C-401.00 N.T.S.

2 ASPHALT PAVEMENT SECTION
C-401.00 SCALE 1" = 4'

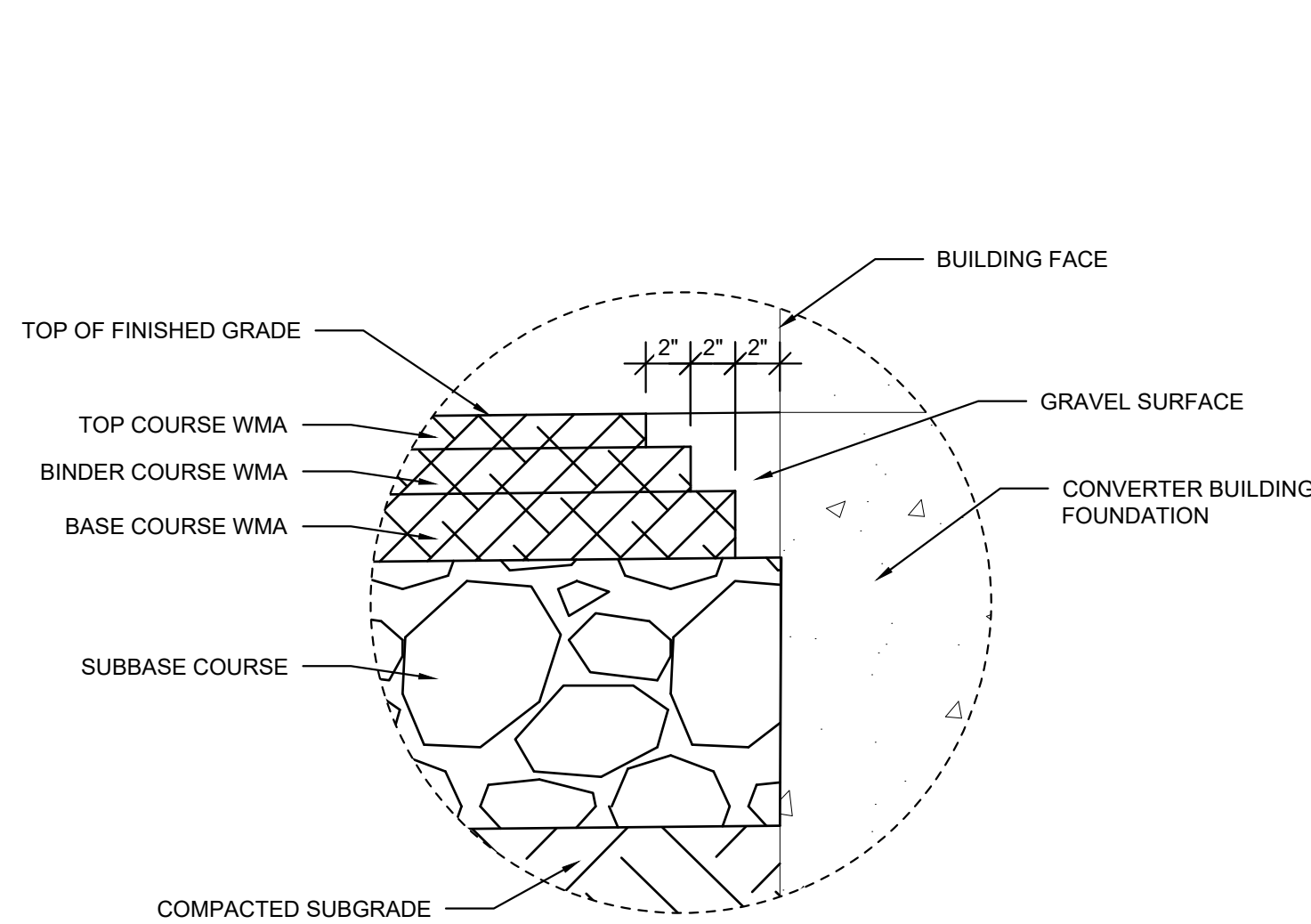
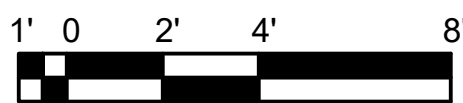

4 PAVEMENT AND BUILDING FACE DETAIL
C-401.00 N.T.S.

Engineering and
Land Surveying, P.C.

370 7th Avenue
SUITE 1604
New York, NY 10001

SOWINSKI
SULLIVAN
ARCHITECTURE+ENGINEERING

25 Mohawk Avenue
Sparta, NJ 07871

CONFIDENTIAL

THESE DRAWINGS ARE CONFIDENTIAL IN NATURE. ANY MISUSE OR UNAUTHORIZED DISTRIBUTION OF THE DRAWINGS CONTAINED HEREIN WILL BE A VIOLATION OF THIS CONFIDENTIALITY REQUIREMENT AND SUBJECT THE VIOLATOR TO LIABILITY. REVIEW OF THESE MATERIALS BY RECEIPT SHALL CONSTITUTE ACCEPTANCE OF THESE TERMS AND THE TERMS OF ANY UNDERLYING CONFIDENTIALITY AGREEMENT HE MAY HAVE. EXCLUDED IN OBTAINING THIS INFORMATION FROM A THIRD PARTY. IF THE RECIPIENT IS NOT IN AGREEMENT WITH THE OBLIGATION OF CONFIDENTIALITY THEN THE DRAWINGS SHALL BE RETURNED TO THE ORIGINATOR.

REV	DESCRIPTION	DRW BY	CHK BY	DATE
B	FINAL SUBMISSION	AB	NP	11/8/22
A	INTERIM SUBMISSION	NS	NP	8/29/22

Kiewit
470 Chestnut Ridge Rd # 2,
Woodcliff Lake, NJ 07677

Hitachi Energy
901 Main Campus Drive
Raleigh, North Carolina 27606

PROJECT

CHPE
Champlain Hudson
Power Express

**Astoria HVDC
Converter Station**

31-45 20th Avenue, Astoria, Queens NY 11105
Block #850 - Lot #310 - BIN #4624437

PAVEMENT & MISCELLANEOUS
SECTIONS - 1



DATE: NOVEMBER 8, 2022
PROJECT NO: 105121
DRAWING BY: A. YOUSEF
CHECKED BY: N. PATEL
DRAWING NO: **C-402.00**
CADD FILE NO: 5 of 6

ISSUED FOR PERMIT

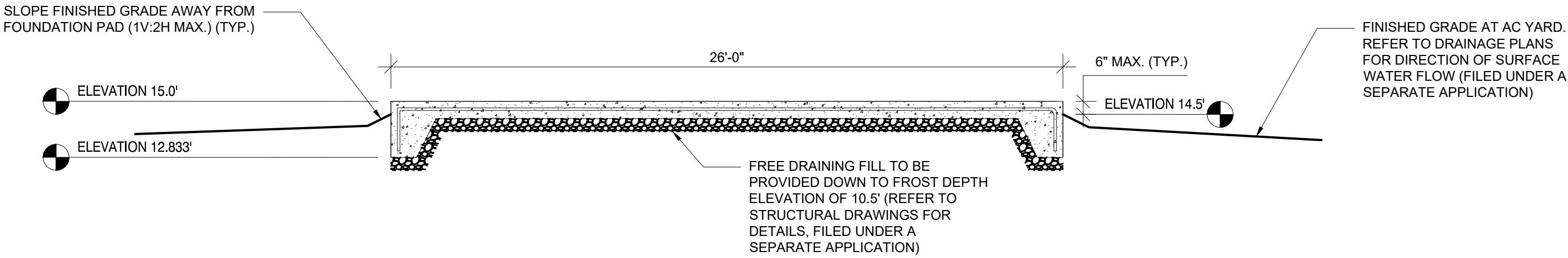

4 FOUNDATION SLAB
C-401.00 SCALE 1" = 4'

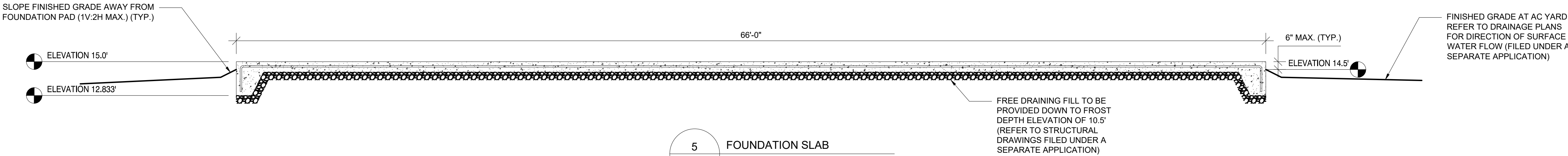

5 FOUNDATION SLAB
C-401.00 SCALE 1" = 4'

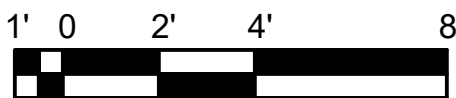

Engineering and
Land Surveying, P.C.

370 7th Avenue
SUITE 1604
New York, NY 10001

SOWINSKI
SULLIVAN
ARCHITECTURE+ENGINEERING

25 Mohawk Avenue
Sparta, NJ 07871

CONFIDENTIAL

THESE DRAWINGS ARE CONFIDENTIAL IN NATURE. ANY MISUSE OR UNAUTHORIZED DISTRIBUTION OF THE DRAWINGS CONTAINED HEREIN WILL BE A VIOLATION OF THIS CONFIDENTIALITY REQUIREMENT AND SUBJECT THE VIOLATOR TO LIABILITY. REVIEW OF THESE MATERIALS BY RECEIPT SHALL CONSTITUTE ACCEPTANCE OF THESE TERMS AND THE TERMS OF ANY UNDERLYING CONFIDENTIALITY AGREEMENT HE MAY HAVE. EXCLUDED IN OBTAINING THIS INFORMATION FROM A THIRD PARTY. IF THE RECIPIENT IS NOT IN AGREEMENT WITH THE OBLIGATION OF CONFIDENTIALITY THEN THE DRAWINGS SHALL BE RETURNED TO THE ORIGINATOR.

A	FINAL SUBMISSION	AJ	NP	11/8/22
A	INTERIM SUBMISSION	NS	NP	8/29/22
REV	DESCRIPTION	DRW BY	CHK BY	DATE



Kiewit

470 Chestnut Ridge Rd # 2,
Woodcliff Lake, NJ 07677

Hitachi Energy

901 Main Campus Drive
Raleigh, North Carolina 27606

PROJECT

CHPE
Champlain Hudson
Power Express

**Astoria HVDC
Converter Station**

31-45 20th Avenue, Astoria, Queens NY 11105
Block #850 - Lot #310 - BIN #4624437

**PAVEMENT & MISCELLANEOUS
SECTIONS - 2**

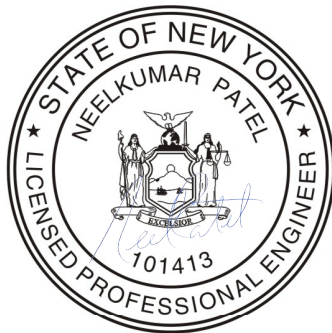

DATE NOVEMBER 8, 2022
PROJECT NO 105121
DRAWING BY A. JALLOW
CHECKED BY N. PATEL
DRAWING NO
C-403.00
CADD FILE NO
6 of 6